

The key of controlling the motion...

2016 ~ 2017

Motion Control & Design

**ROTARY DAMPERS
SHOCK ABSORBERS
HELICAL ISOLATORS**

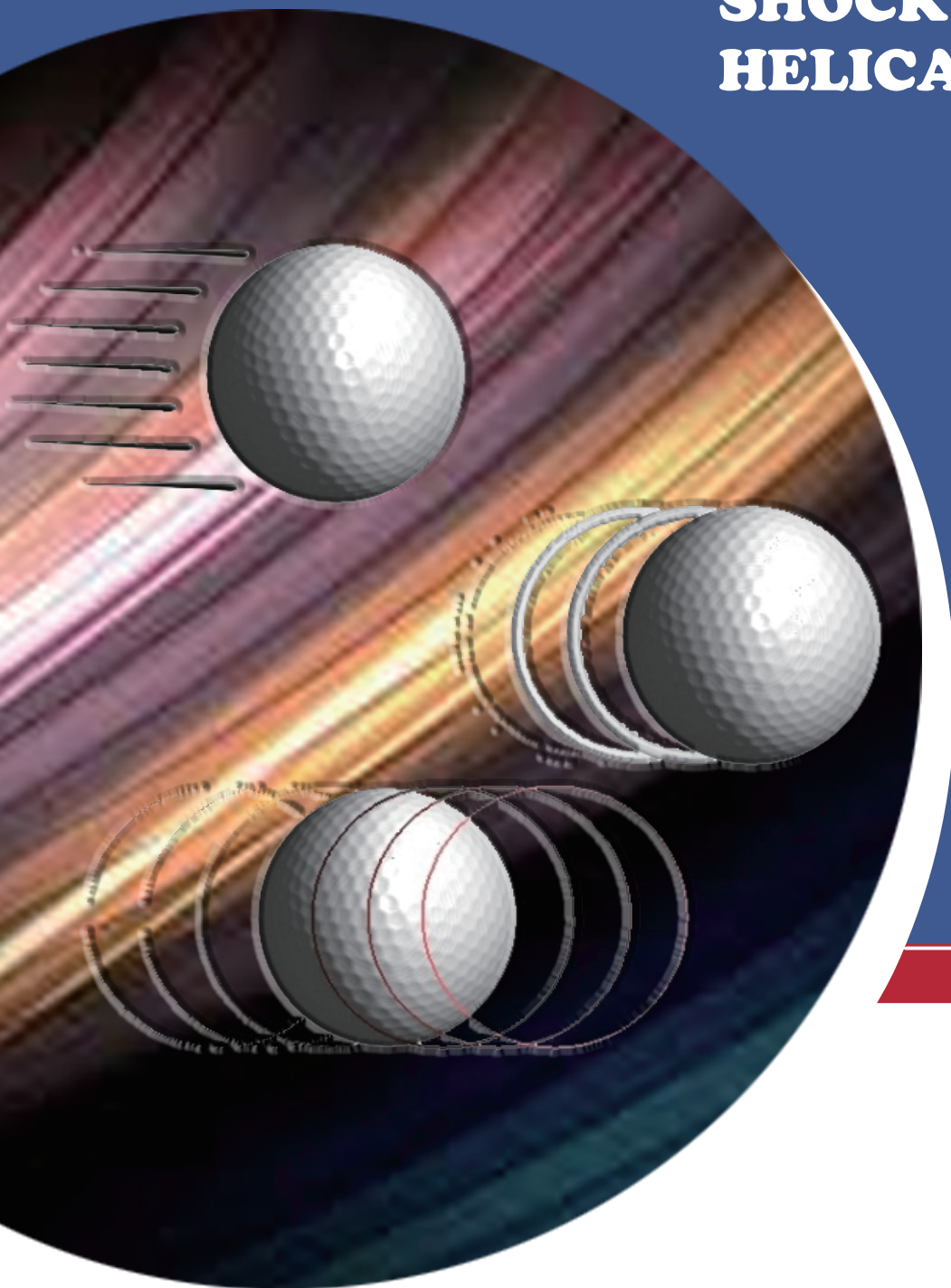

Gorago Srl - Milano

FUJI LATEX CO., LTD.

Soft Absorber

FPD-0715/0725/0745/0750/0755/0760 Series



Model Description

F P D - 0 7 4 5 A 1 - S W

① ② ③ ④ ⑤ ⑥

- ① Series name
- ② External diameter stroke
- ③ Stroke
- ④ With/Without self-returning
A : With Returning Spring
B : Without Returning Spring
- ⑤ Characteristics Number
1 : Low-load (low thrust) specifications
2 : Medium-load (medium thrust) specifications
3 : High-load (high thrust) specifications
- ⑥ Symbols indicating form SW: Without cap
CW : With T-shaped cap
BW : With ball head type cap

External Dimensions

FPD-0715/0745/0750/0755/0760 External Dimensions

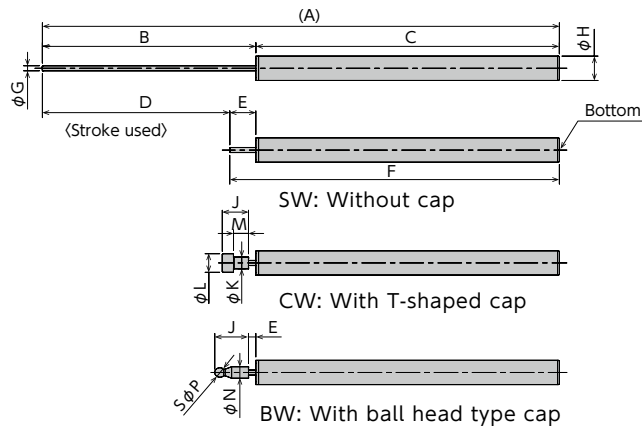

FPD-0725 External Dimensions

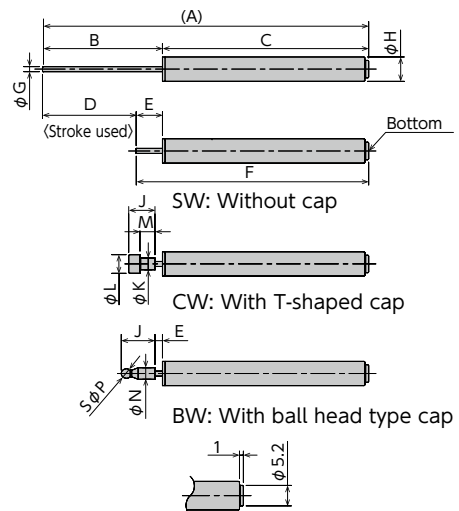

Fig. 1 Bottom Shape of FPD-0725 Series

*FPD-0715A Series are provided with Returning Spring Type only

*The shape of the bottom of FPD-0725 series differs from FPD-07□□ series. (Ref. Fig. 1)

Dimensions

MODEL	A	B	C	D	E	F	G	H	J	K	L	M	N	P	Mass(g)				
FPD-0715A□-SW	66	22	44	15	7	51	1.5	7.2	-	-	-	-	-	-	2.7				
FPD-0715A□-CW	68	24			2	53			7	3.5	5.5	4	-	-	2.9				
FPD-0725A□-SW	87	32	55	25	7	62			-	-	-	-	-	-	3.4				
FPD-0725A□-CW	89	34			2	64			7	3.5	5.5	4	-	-	3.6				
FPD-0725B□-SW	87	32			7	62			-	-	-	-	-	-	3.2				
FPD-0725B□-CW	89	34			2	64			7	3.5	5.5	4	-	-	3.4				
FPD-0725B□-BW	91	36			81	45			12	93			9	-	-	-	3.4	2.8	3.3
FPD-0745A□-SW	138	57											-	-	-	-	-	-	4.9
FPD-0745A□-CW	140	59	7	95					7	3.5	5.5	4	-	-	5.1				
FPD-0750B□-SW	138	57	50	7		88			-	-	-	-	-	-	4.7				
FPD-0750B□-CW	140	59		2		90			7	3.5	5.5	4	-	-	4.9				
FPD-0750B□-BW	142	61	92	55	12	104			9	-	-	-	3.4	2.8	4.8				
FPD-0755A□-SW	159	67							7	106	-	-	-	-	-	-	5.6		
FPD-0755A□-CW	161	69			7	99			7	3.5	5.5	4	-	-	5.8				
FPD-0760B□-SW	159	67		60	2	101			-	-	-	-	-	-	5.3				
FPD-0760B□-CW	161	69							7	3.5	5.5	4	-	-	5.5				
FPD-0760B□-BW	163	71							9	-	-	-	3.4	2.8	5.4				

*The characteristics number 1, 2, or 3 is inserted in the □.

●Products specification might be changed without notice.

Specifications

MODEL	Max absorption every J (kgf·m)	Speed range m/s	Cylinder cap color
FPD-0715A1-□	0.2(0.02)	Under 0.3	Black
FPD-0715A2-□	0.28(0.028)	Under 0.3	White
FPD-0715A3-□	0.3(0.03)	Under 0.3	Blue
FPD-0725A1-□	0.25(0.025)	Under 0.4	Black
FPD-0725A2-□	0.45(0.045)	Under 0.4	White
FPD-0725A3-□	0.8(0.08)	Under 0.4	Blue
FPD-0725B1-□	0.25(0.025)	Under 0.4	Black
FPD-0725B2-□	0.45(0.045)	Under 0.4	White
FPD-0725B3-□	0.8(0.08)	Under 0.4	Blue
FPD-0745A1-□	0.7(0.07)	Under 0.5	Black
FPD-0745A2-□	1.25(0.125)	Under 0.5	White
FPD-0745A3-□	2.5(0.25)	Under 0.5	Blue
FPD-0750B1-□	0.7(0.07)	Under 0.5	Black
FPD-0750B2-□	1.25(0.125)	Under 0.5	White
FPD-0750B3-□	2.5(0.25)	Under 0.5	Blue
FPD-0755A1-□	0.75(0.075)	Under 0.5	Black
FPD-0755A2-□	1.6(0.16)	Under 0.5	White
FPD-0755A3-□	2.9(0.29)	Under 0.5	Blue
FPD-0760B1-□	0.75(0.075)	Under 0.5	Black
FPD-0760B2-□	1.6(0.16)	Under 0.5	White
FPD-0760B3-□	2.9(0.29)	Under 0.5	Blue

Common Specifications

Recovering power of piston rod N(kgf)	With returning spring : ≤ 5 (0.5), Without returning spring : ≤ 1.5 (0.15)
Main unit material	Resin
Range of operating temperature, degree s C	5~40°C

Absorbable energy range under a horizontal inertial collision condition

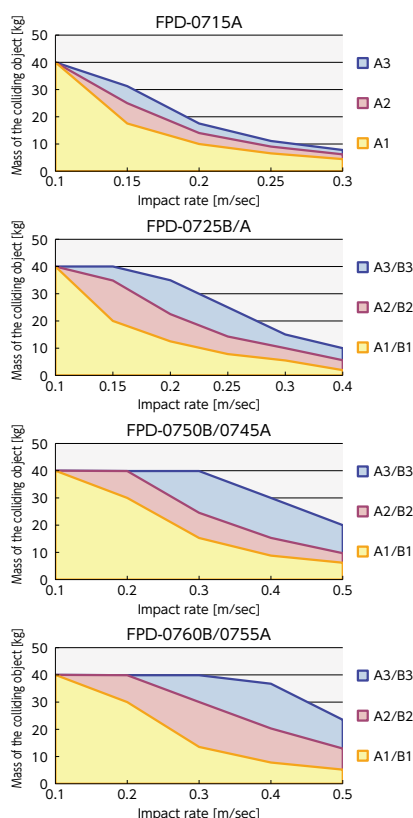

Precautions for Use

- * Use with an external stopper.
- * Ensure that sufficient mounting strength is secured for this product.
- * 2 or more of this product can be used in parallel.
- * Do not use this product in a vacuum or a location where it may come in contact with oil.
- * Ensure that an eccentric load is not applied to the soft absorber.
- * Do not press the piston rod of soft absorber in beyond the stroke used.
(This will cause the incomplete return of the piston rod and other failures.)
- * Do not pull the soft absorber beyond the stroke used.
(This will cause the damage or failure of the soft absorber.)
- * When the gap between the pressing time and the returning time of the piston rod is large, the durability may be affected. Confirm its performance in an actual machine before use.
- * A falling impact will cause a deformation, damage, etc. Please handle with special care.

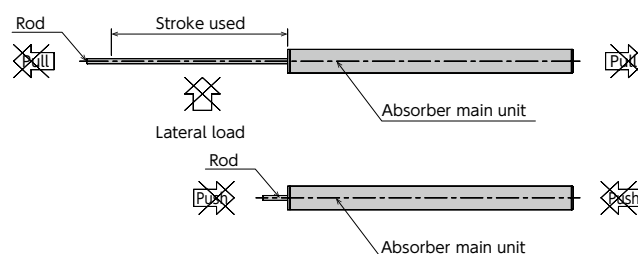

*The absorbable energy ranges above represent the properties under a condition where no thrusting force exists.

Soft Absorber

FPD-1030/1050/1060/1070/10100 Series



Model Description

F P D - 1 0 3 0 B 1 - S W

① ② ③ ④ ⑤ ⑥

- ① Series name
- ② External diameter
- ③ Stroke
- ④ Self-return presence A : With returning spring
 B : Without returning spring
- ⑤ Symbols indicating characteristics 1 : Low load (low thrust) specifications
 2 : Medium load (medium thrust) specifications
 3 : High load (high thrust) specifications
- ⑥ Symbols indicating shape SW : Without cap
 CW : With cap

External Dimensions

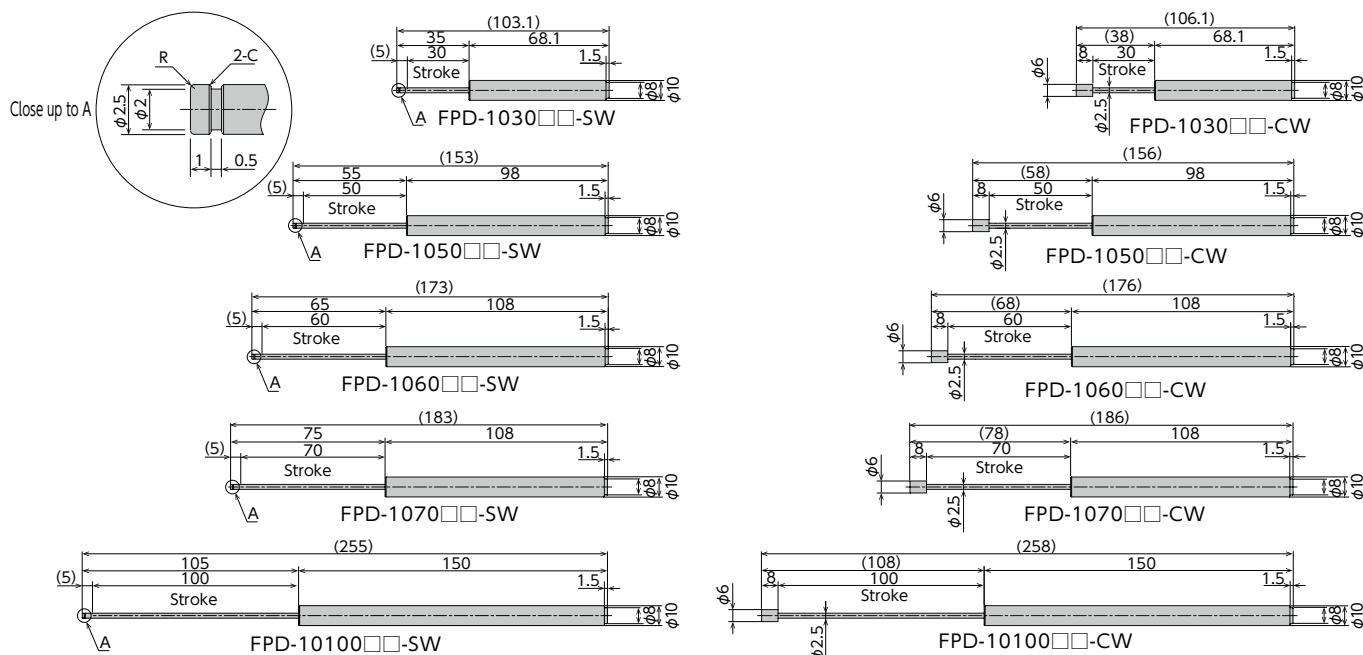

*The FPD-1070B series can be sold only without the spring.

*The FPD-1060A series can be sold only with the spring.

*E-type retaining ring (nominal 2) can be attached to top of 5 type (A in above drawing).

Specifications

Stroke[mm]	FPD-1030=30, FPD-1050=50, FPD-1060=60, FPD-1070=70, FPD-10100=100
External diameter[mm]	φ10
Mass[g]	FPD-1030-SW=8, FPD-1030-CW=8.5, FPD-1050-SW=12, FPD-1050-CW=12.5, FPD-1060-SW=13.5, FPD-1060-CW=14, FPD-1070-SW=13.5, FPD-1070-CW=14, FPD-10100-SW=18.5, FPD-10100-CW=19
Main unit material	Resin
Operating temperature[°C]	5~40

●Products specification might be changed without notice.

Motion performance

Model	Load [kg]	Thrust [N]	Impact rate [m/sec]	Motion time [sec]	Recovering power of the piston rod [N]	※Bottom color
FPD-1030A1-□W	10	6	0.3	0.2~1.5	5 or less	Black
FPD-1030A2-□W	10	8	0.3	0.2~1.5	5 or less	White
FPD-1030A3-□W	10	13	0.3	0.3~1.6	5 or less	Grey
FPD-1030B1-□W	10	5	0.3	0.2~1.2	1.5 or less	Black
FPD-1030B2-□W	10	8	0.3	0.2~1.2	1.5 or less	White
FPD-1030B3-□W	10	13	0.3	0.3~1.3	1.5 or less	Grey
FPD-1050A1-□W	10	8	0.5	0.3~2.0	6 or less	Black
FPD-1050A2-□W	10	10	0.5	0.4~2.2	6 or less	White
FPD-1050A3-□W	10	15	0.5	0.5~2.5	6 or less	Grey
FPD-1050B1-□W	10	5	0.5	0.3~2.0	1.5 or less	Black
FPD-1050B2-□W	15	8	0.5	0.4~2.2	1.5 or less	White
FPD-1050B3-□W	15	13	0.5	0.5~2.5	1.5 or less	Grey
FPD-1060A1-□W	10	8	0.5	0.3~2.0	6 or less	Black
FPD-1060A2-□W	10	10	0.5	0.4~2.2	6 or less	White
FPD-1060A3-□W	10	15	0.5	0.5~2.5	6 or less	Grey
FPD-1070B1-□W	10	5	0.5	0.3~2.0	1.5 or less	Black
FPD-1070B2-□W	15	8	0.5	0.4~2.2	1.5 or less	White
FPD-1070B3-□W	15	13	0.5	0.5~2.5	1.5 or less	Grey
FPD-10100B1-□W	10	5	0.5	0.8~3.0	1.5 or less	Black
FPD-10100B2-□W	15	8	0.5	0.8~3.2	1.5 or less	White
FPD-10100B3-□W	15	15	0.5	1.5~5.5	1.5 or less	Grey

The above performance was measured using Fuji Latex' s instruments. So, please select dampers accordingly, and confirm operation on actual machines before selecting final models.

[Measurement conditions]

* Bottom color

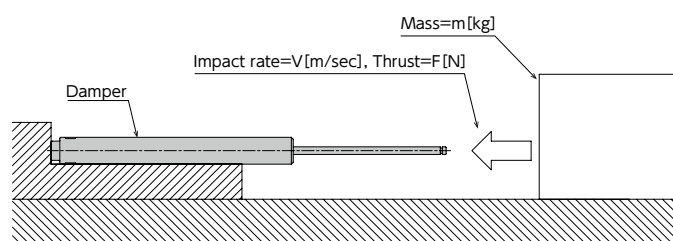

Precautions in Use

- * Do not use this product without carefully reading the attached owner' s manual.
- * Use with an external stopper.
- * Ensure that sufficient mounting strength is secured for this product.
- * 2 or more of this product can be used in parallel.
- * Do not use this product in a vacuum or a location where it may come in contact with oil.
- * Ensure that an eccentric load (lateral load) is not applied to the soft absorber.
- * Do not pull the piston rod of the soft absorber more than stroke.
(This will cause air to get inside the soft absorber, causing ineffective stroke, abnormal sounds, and other damage to the soft absorber.)
- * Do not push the piston rod of the soft absorber more than stroke.
(This will cause recovery failure and other damage to the soft absorber.)

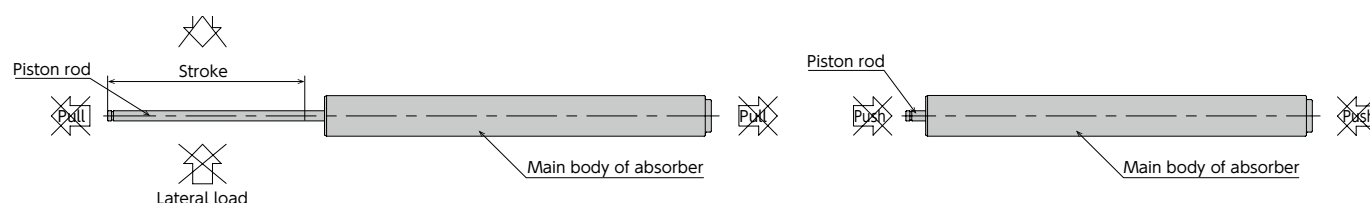

Soft Absorber

FPD-0805 Series



Model Description

F P D - 0 8 0 5 A 5 - S W

① ② ③ ④ ⑤ ⑥

① Series name

② External diameter

③ Stroke

④ Characteristics number

A1: Low-load specifications

A2: High-load specifications

⑤ Symbols indicating form

S : S type (Standard)

C : C type (Cap)

* Please refer to the external dimensions.

⑥ Symbols indicating color W : White

External Dimensions

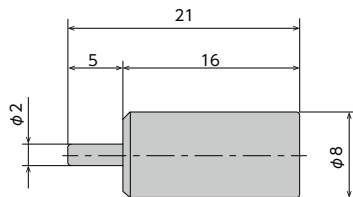

FPD-0805A□-SW (S type)

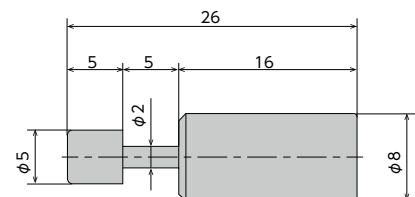

FPD-0805A□-CW (C type)

Specifications

MODEL	Max absorption energy J (kgf·m)	Impact speed range m/s	Push Speed rang mm/s	Max load thrust N(kgf)	Cylinder cap color
FPD-0805A1	0.2	0.5 or lower	-	-	Black
FPD-0805A2	0.3	0.5 or lower	-	-	White
FPD-0805A5	-	-	50 or lower	80(8)	Blue
FPD-0805A7	-	-	20 or lower	100(10)	Brown

* For the motion-time of each load, please see the next page.

Common Specifications

Stroke (S/C type)	mm	5	Main Unit Material	Resin
Recovering power of piston rod	N(kgf)	6 (0.6) or lower	Range of operating temperature, degrees °C	5~40
Mass	g	S type =1.3, C type =1.5		

●Products specification might be changed without notice.

Graph of Operating Time by Load

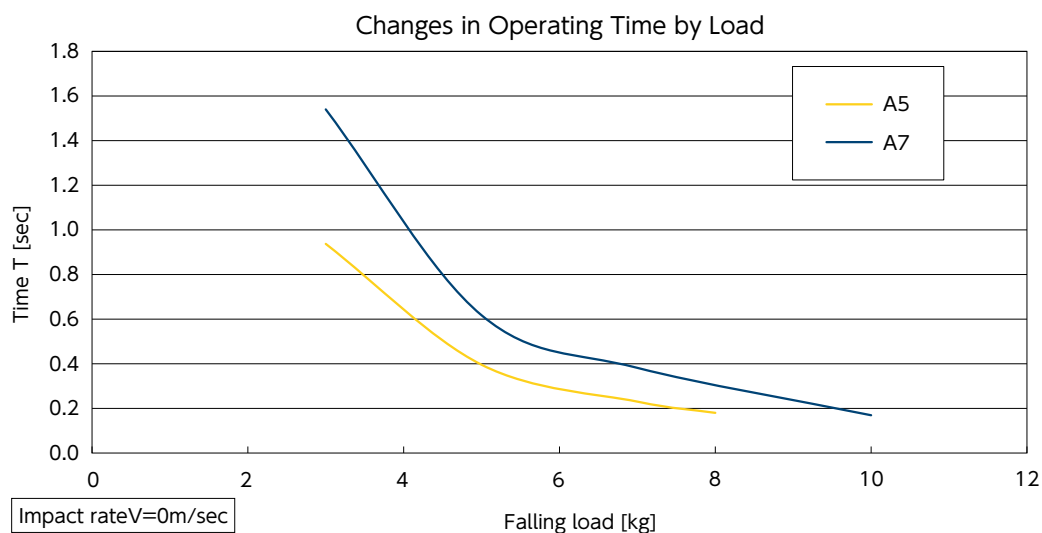
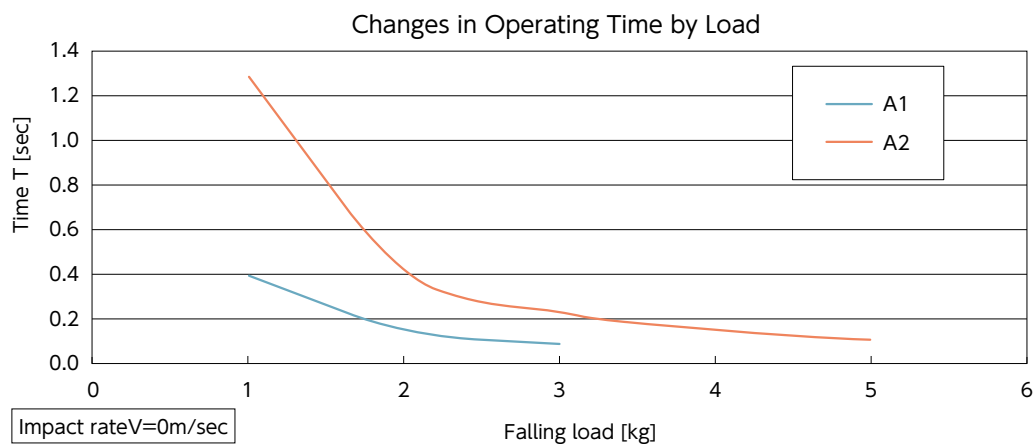

Precautions for Use

- * Use with an external stopper.
- * Ensure that sufficient mounting strength is secured for this product.
- * 2 or more of this product can be used in parallel.
- * Do not use this product in a vacuum or a location where it may come in contact with oil.
- * Ensure that an eccentric load is not applied to the soft absorber.
Allowable eccentric angle: within $\pm 2.5^\circ$
- * Do not pull the soft absorber beyond the stroke used.
(This will cause the damage or failure of the soft absorber.)
- * Do not press the piston rod of soft absorber in beyond the stroke used.
(This will cause the incomplete return of the piston rod, and other failures.)
- * When the gap between the pressing time and the returning time of the piston rod is large, the durability may be affected. Confirm its performance in an actual machine before use.

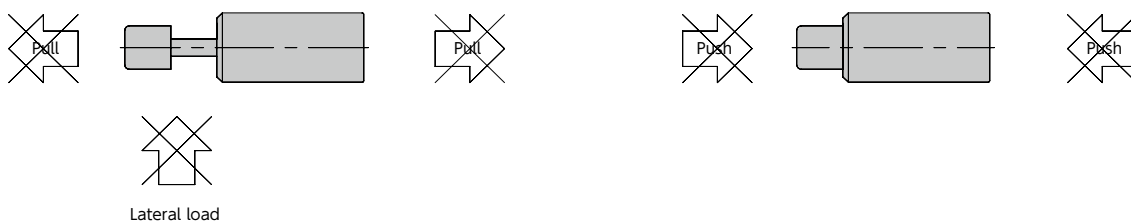

Soft Absorber

FPD-1006/1008 Series



Model Description

F P D - 1 0 0 6 A 8 - S W

① ② ③ ④ ⑤ ⑥ ⑦

- ① Series name
- ② External diameter
- ③ Stroke
- ④ With/Without self-returning
A : With returning spring
B : Without returning spring
- ⑤ Characteristics number
3, 5 : High-load specifications
8, 12, 15 : Low-load specifications
- ⑥ Symbols indicating form
S : S type (Standard)
C : C type (Cap)
*Please refer to the external dimensions.
- ⑦ Symbols indicating color W : White

External Dimensions

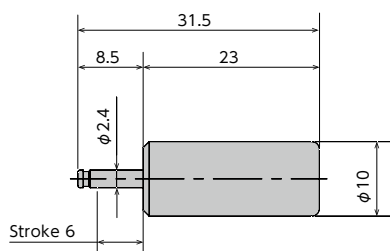

FPD-1006A□-SW (S type)

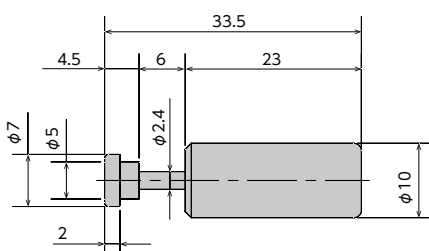

FPD-1006A□-CW (C type)

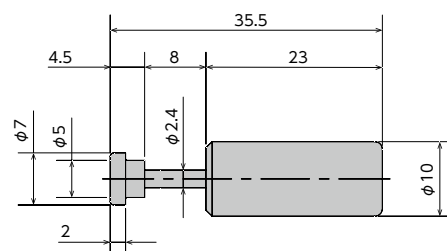

FPD-1008B□-CW (C type)

* FPD-1006 Series are supplied only in types implementing a return spring, and FPD-1008 Series are supplied only in C-Type without a return spring.

Specifications

MODEL	Max absorption energy J (kgf·m)	Impact speed range m/s	Push Speed rang mm/s	Max load thrust N(kgf)	Cylinder cap color
FPD-1006A3	0.3	Under 0.5	-	-	Black
FPD-1006A5	0.4	Under 0.5	-	-	White
FPD-1006A8	-	-	Under 40	120(12)	Blue
FPD-1006A12	-	-	Under 30	160(16)	Brown
FPD-1006A15	-	-	Under 20	200(20)	Gray
FPD-1008B3	0.4	Under 0.5	-	-	Black
FPD-1008B5	0.5	Under 0.5	-	-	White
FPD-1008B8	-	-	Under 40	120(12)	Blue
FPD-1008B12	-	-	Under 30	160(16)	Brown
FPD-1008B15	-	-	Under 20	200(20)	Gray

* For the motion-time of each load, please see the next page.

Common Specifications

Stroke	FPD-1006 6mm	Mass	FPD-1006 S type 2.9g
	FPD-1008 8mm		FPD-1006 C type 3.1g
Recovering power of piston rod N(kgf)	FPD-1006 Under 5(0.5)		FPD-1008 C type 3.0g
	FPD-1008 Under 1(0.1)	Main unit material	Resin
		Range of operating temperature, degrees °C	5~40

●Products specification might be changed without notice.

Graph of Operating Time by Load

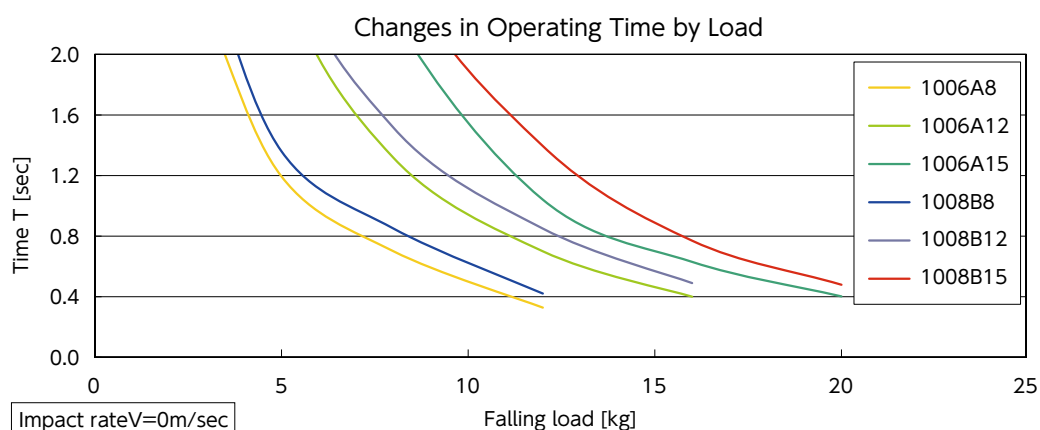
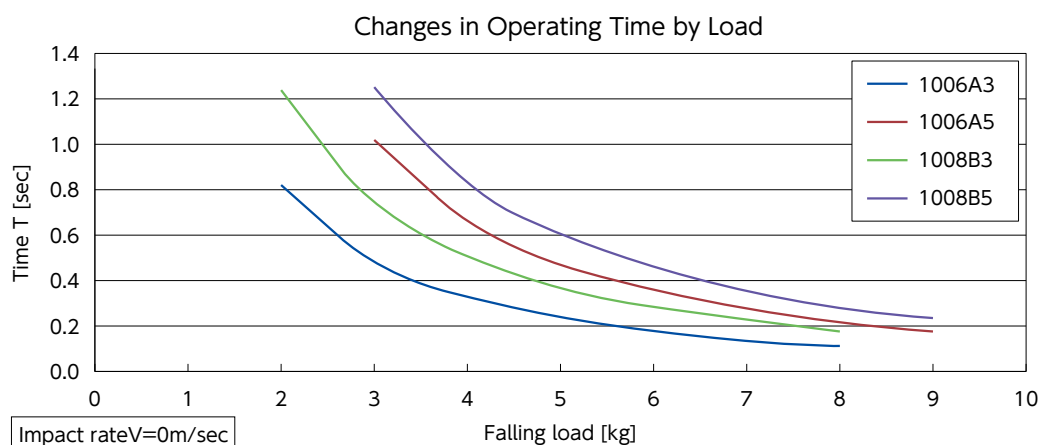

Precautions for Use

- * Use with an external stopper.
- * Ensure that sufficient mounting strength is secured for this product.
- * 2 or more of this product can be used in parallel.
- * Do not use this product in a vacuum or a location where it may come in contact with oil.
- * Ensure that an eccentric load is not applied to the soft absorber.
Allowable eccentric angle: within $\pm 2.5^\circ$
- * Do not pull the soft absorber beyond the stroke used.
(This will cause the damage or failure of the soft absorber.)
- * Do not press the piston rod of soft absorber in beyond the stroke used.
(This will cause the incomplete return of piston rod, and other failures.)
- * When the gap between the pressing time and the returning time of the piston rod is large, the durability may be affected. Confirm its performance in an actual machine before use.

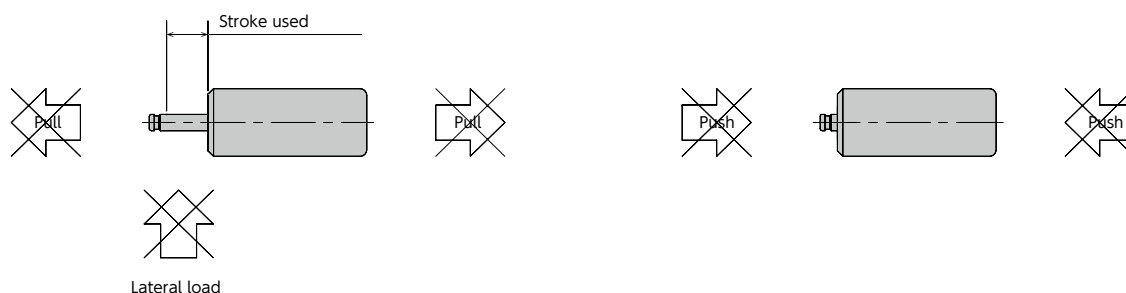

Soft Absorber

FPD-1012 Series



Model Description

F P D - 1 0 1 2 A 1 - S W

① ② ③ ④ ⑤ ⑥

- ① Base model
- ② External diameter
- ③ Stroke
- ④ Symbols indicating characteristics
 - A1 : Low-load specifications
 - A3 : Medium-load specifications
 - A5 : High-load specifications
- ⑤ Symbols indicating form
 - S : S type (Standard)
 - C : C type (Cap)
 - R : R type (Elastomer cap)
 - D : D type (Eccentric angle cap)
 - * Please refer to the external dimensions.
- ⑥ Color symbols
 - W : White B : Black

External Dimensions

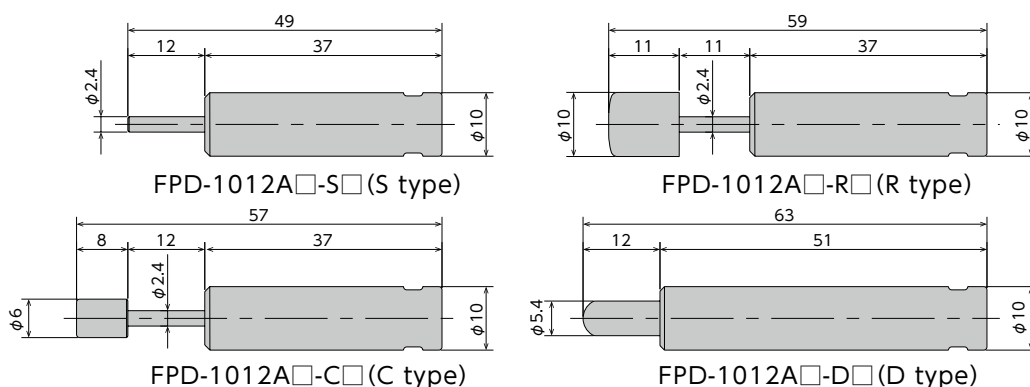

Specifications

MODEL	load [kg]	Max absorption energy J (kgf·m)	Speed rang m/s	Cylinder cap color
FPD-1012A1	1	0.5 (0.05)	0.5 or lower	Black
FPD-1012A3	3	0.8 (0.08)	0.5 or lower	White
FPD-1012A5	5	1.0 (0.10)	0.5 or lower	Blue

* For the motion-time of each load, please see the next page.

Common Specifications

Stroke (S/C/D type)	mm	12	Mass	g	S type= 4.5.C type= 5.0.R type=5.7.D type =6.0
Stroke (R type)	mm	11	Main unit material		Resin
Recovering power of the piston rod	N (kgf)	3 (0.3) or less	Operating temperature	℃	5~40

Impact rate and mass of the colliding object in freefall

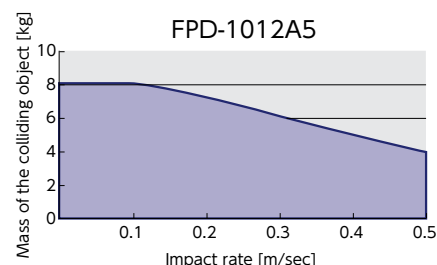
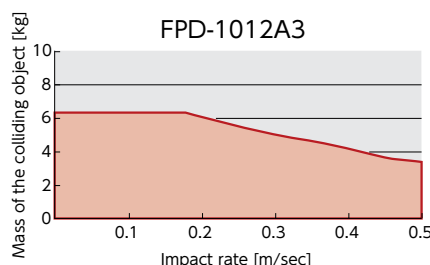
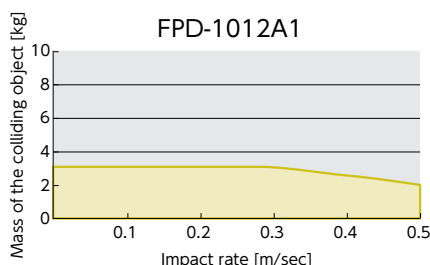

●Products specification might be changed without notice.

Characteristics Graph

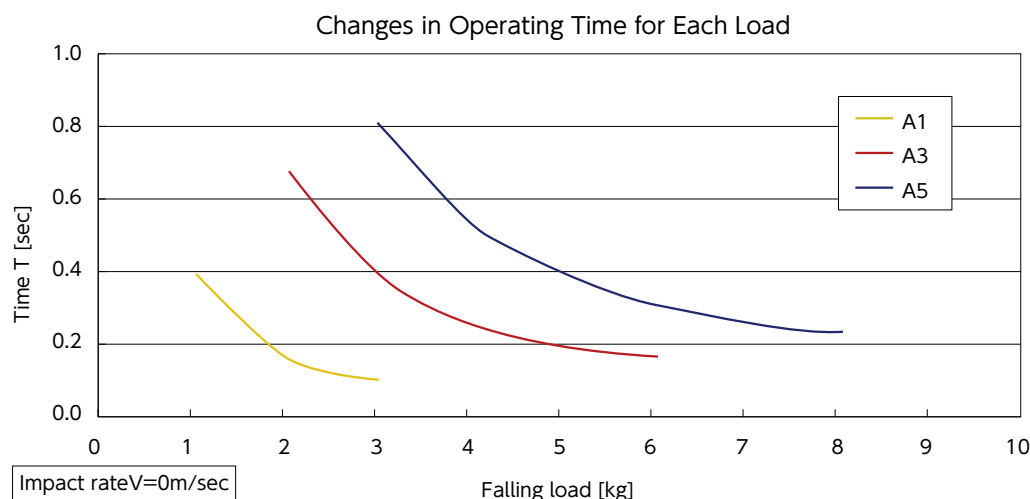

Optional Parts

OP-200-01B/W S/C/R type

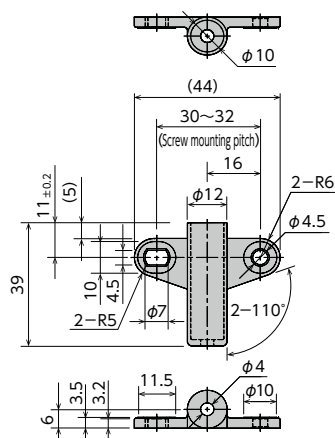

Screw: M4 (Truss screw)
Recommended tightening torque : 0.5N·m

OP-200-02B/W D type

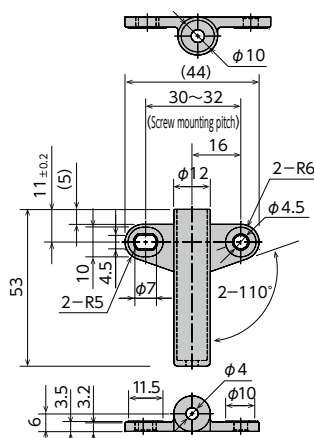

Screw: M4 (Truss screw)
Recommended tightening torque : 0.5N·m

OP-200-03B/W S/C/R/D type

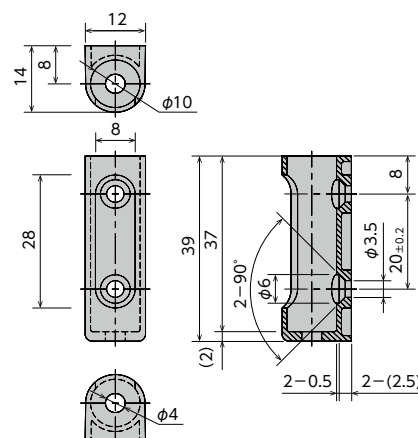

Screw: M3 (Flat head screw)
Recommended tightening torque : 0.3N·m

- *These adaptors are dedicated for FPD-1012A series
- *They make it easy to install absorbers.
- *There are 2 colors: white and black.
- *Material : Polyacetal (POM)

Precautions for Use

- * Do not use this product without carefully reading the attached owner's manual.
- * Use with an external stopper.
- * Ensure that sufficient mounting strength is secured for this product.
- * 2 or more of this product can be used in parallel.
- * Do not use this product in a vacuum or a location where it may come in contact with oil.
- * Ensure that an eccentric load is not applied to the soft absorber.
 - S/C/R type ... Allowable eccentric angle: $\pm 2.5^\circ$ or less
 - D type Allowable eccentric angle: $\pm 6^\circ$ or less
- * Do not pull the piston rod of the soft absorber.
(This will cause air to get inside the soft absorber, causing ineffective stroke, abnormal sounds, and other damage to the soft absorber.)
- * The difference between the speed of stroke and return of piston rod might influence the durability of the damper. So, please confirm sufficient performance on actual machine before use.

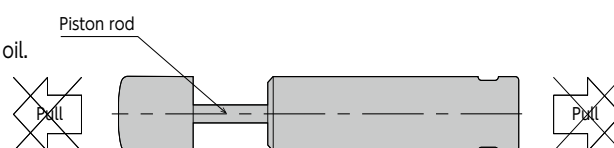

Soft Absorber

FPD-1016 Series



Model Description

F P D - 1 0 1 6 A 3 0 - S W

① ② ③ ④ ⑤ ⑥

- ① Series name
- ② External diameter
- ③ Stroke
- ④ Symbols indicating characteristic
A30: Low-load specification
A40: High-load specification
- ⑤ Symbols indicating form
S: S type (Standard)
*Please refer to the external dimensions
- ⑥ Symbols indicating color W : White

External Dimensions

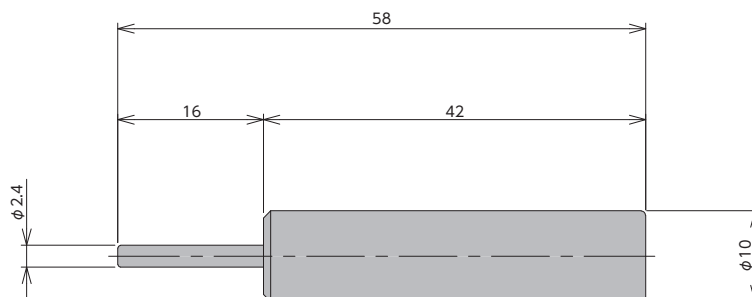

FPD-1016A□ -SW

Specifications

MODEL	Push speed range mm/s	Max load thrust N (kgf)	Cylinder cap color
FPD-1016A30-SW	15 or lower	300(30)	black
FPD-1016A40-SW		400(40)	white

* For the motion-time of each load, please see the next page.

Common Specifications

Stroke	mm	16	Mass	g	5.2
			Main unit material		Resin
Recovering power of piston rod N(kgf)		10 (1.0) or lower	Range of operating temperature °C		5~40

Waveform of Resistance

Waveform of Resistance: When pressing constant speed (F.Y.R.)

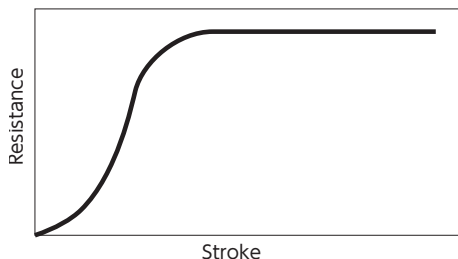

●Products specification might be changed without notice.

Graph of Operating Time by Load

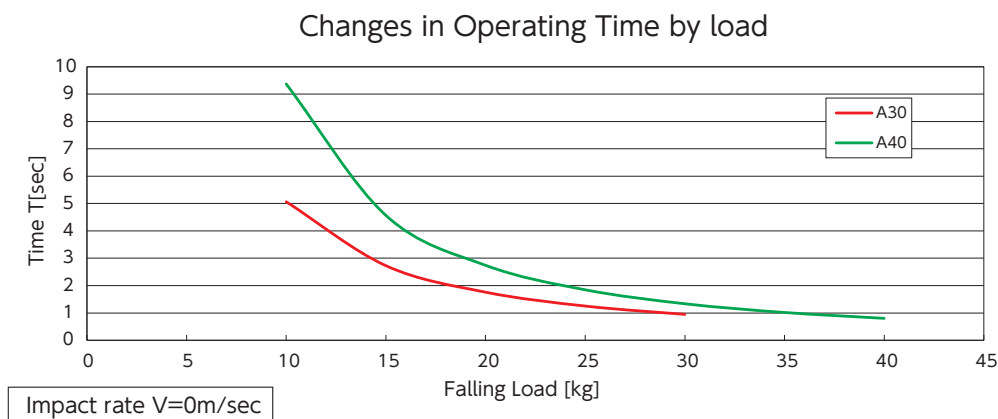

Graph of Resistance by Push Speed

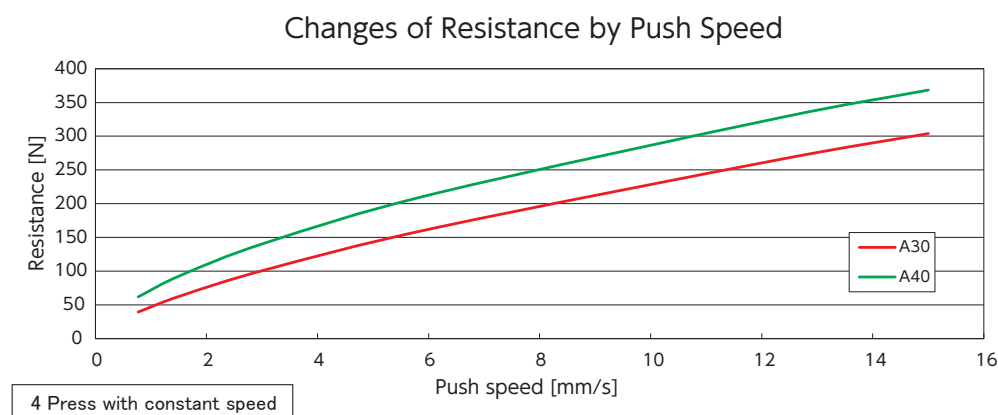

Precautions for Use

- * Use with an external stopper.
- * Ensure that sufficient mounting strength is secured for this product.
- * 2 or more of this product can be used in parallel.
- * Do not use this product in a vacuum or a location where it may come in contact with oil.
- * Ensure that an eccentric load is not applied to the soft absorber.
Allowable eccentric angle: within $\pm 2.5^\circ$
- * Do not pull the soft absorber beyond the stroke used.
(This will cause the damage or failure of the soft absorber.)
- * Do not press the piston rod of soft absorber in beyond the stroke used.
(This will cause the incomplete return of piston rod, and other failures.)
- * When the gap between the pressing time and the returning time of the piston rod is large, the durability may be affected. Confirm its performance in an actual machine before use.

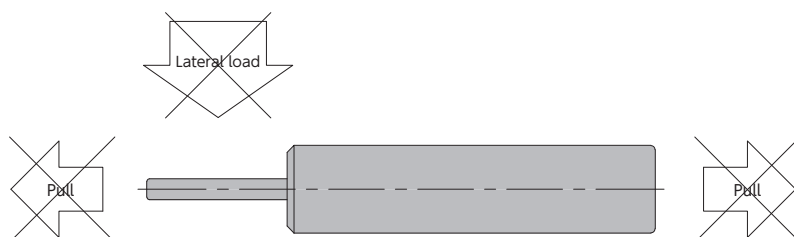

Soft Absorber

FPD-1018 Series



Model Description

F	P	D	—	1	0	1	8	A	1	5	—	S	W
①				②		③		④				⑤	⑥

① Series name

② External diameter

③ Stroke

④ Symbols indicating characteristics

A15 : Low-load specifications

A20 : High-load specifications

⑤ Symbols indicating form

S : S type (Standard)

C : C type (Cap)

R : R type (Elastomer cap)

* Please refer to the external dimensions.

⑥ Symbols indicating color W : White

External Dimensions

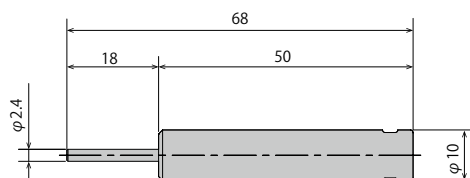

FPD-1018A□-SW (S type)

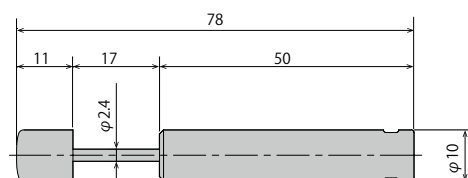

FPD-1018A□-RW (R type)

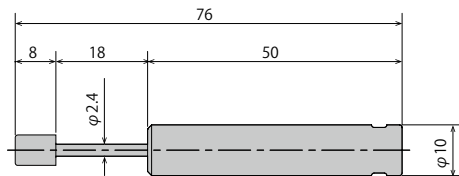

FPD-1018A□-CW (C type)

Specifications

MODEL	Max absorption energy J (kgf·m)	Impact speed range m/s	Cylinder cap color
FPD-1018A15	1.2 (0.12)	0.5 or lower	Brown
FPD-1018A20	1.5 (0.15)	0.5 or lower	Gray

* For the motion-time of each load, please see the next page.

Common Specifications

Stroke (S/C type)	mm	18	Mass	g	S type = 6.1, C type = 6.6, R type = 7.3
Stroke (R type)	mm	17	Main unit material		Resin
Recovering power of piston rod	N (kgf)	6 (0.6) or lower	Range of operating temperature, degrees	°C	5~40

Graph of Impact Rate/Mass of Colliding Object Under the Condition of Free Fall

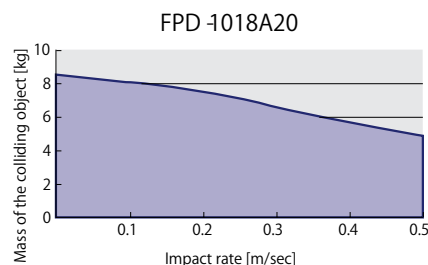
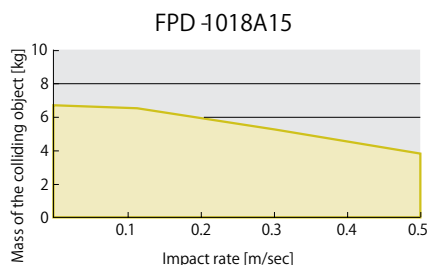

●Products specification might be changed without notice.

Graph of Operating Time by Load

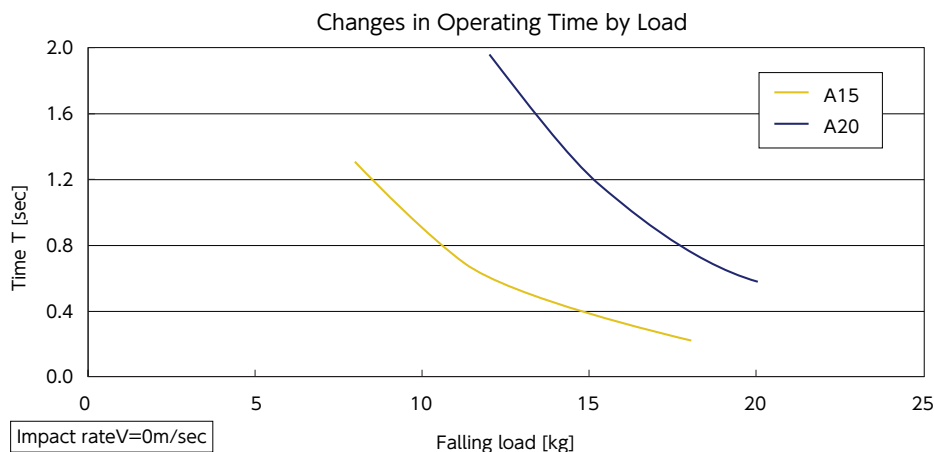

Optional Parts

OP-200-01B/W

MODEL
OP-200-01B
OP-200-01W

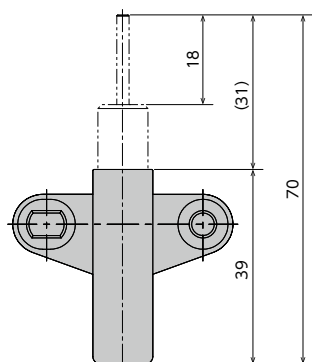

Screw used: M4 (truss screw)
Recommended tightening torque: 0.5 N·m

OP-200-02B/W

MODEL
OP-200-02B
OP-200-02W

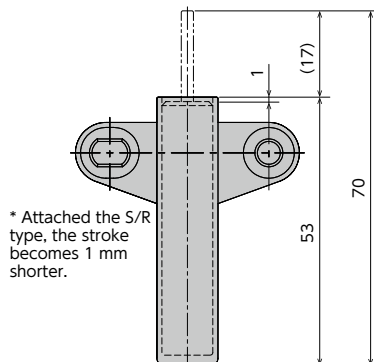

Screw used: M4 (truss screw)
Recommended tightening torque: 0.5 N·m

OP-200-03B/W

MODEL
OP-200-03B
OP-200-03W

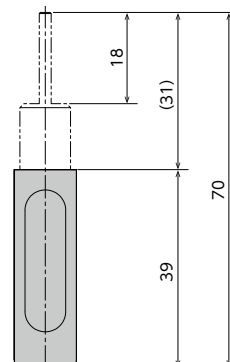

Screw used: M3 (countersunk screw)
Recommended tightening torque: 0.3 N·m

- The diagram indicates the mounting dimensions of the adaptor for the FPD-1012 series used in combination with the FPD-1018S type.
- For the details of the adaptor specifications, please see the pages of the FPD-1012 series.

Precautions for Use

- * Use with an external stopper.
- * Ensure that sufficient mounting strength is secured for this product.
- * 2 or more of this product can be used in parallel.
- * Do not use this product in a vacuum or a location where it may come in contact with oil.
- * Ensure that an eccentric load is not applied to the soft absorber.
 - S/C/R type ... Allowable eccentric angle: $\pm 2.5^\circ$ or less
- * Do not pull the piston rod of the soft absorber.
(This will cause air to get inside the soft absorber, causing ineffective stroke, abnormal sounds, and other damage to the soft absorber.)
- ※When the gap between the pressing time and the returning time of the piston rod is large, the durability may be affected. Confirm its performance in an actual machine before use.

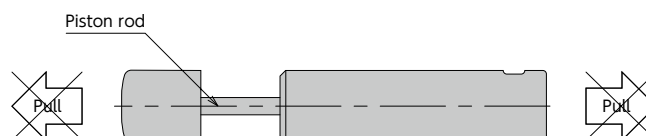

Soft Absorber

FPR-1040 Series



Model Description

F P R - 1 0 4 0 B 1 - U

① ② ③ ④ ⑤ ⑥

- ① Series name
- ② External diameter
- ③ Stroke
- ④ With/Without cover B : Without cover
 C : With cover
- ⑤ Symbols indicating characteristics
 - 1 : Low-load (low thrust) specifications
 - 2 : Medium-load (medium thrust) specifications
 - 3 : High-load (high thrust) specifications
- ⑥ Symbols indicating form U : With crevice

External Dimensions

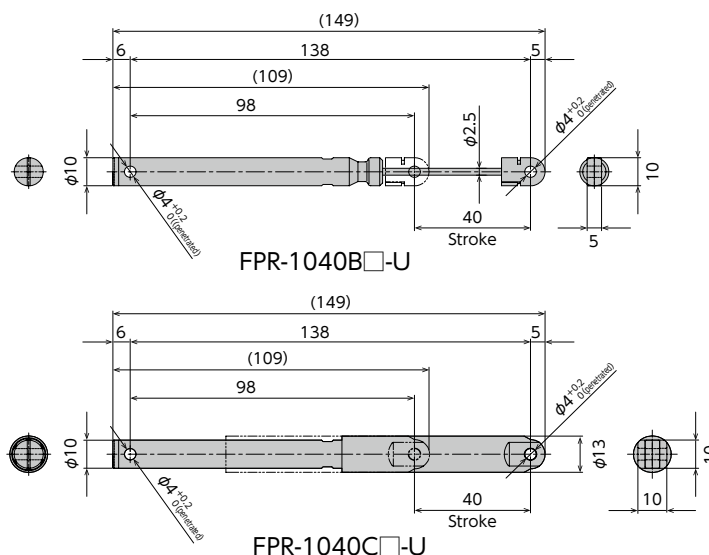

Specification

Model	Measuring speed [m/sec]	Resistance [N] ^{※1}	CAP COLOR ^{※2}
FPR-1040□1-U	0.04	30	Black
FPR-1040□2-U	0.04	45	White
FPR-1040□3-U	0.04	60	Gray

※ 1 The resistance generated is a reference value according to our measurement conditions.

● □ will be filled in with either B or C

※ 2 Cap color

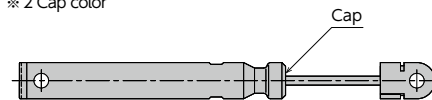

Common Specification

Stroke[mm]	40
External diameter[mm]	φ10
Mass[g] (reference value)	FPR-1040B-U=11.6, FPR-1040C-U=14.2
Main unit material	Resin
Operating temperature[°C]	5~40

●Products specification might be changed without notice.

Graph of Operating Time by Load

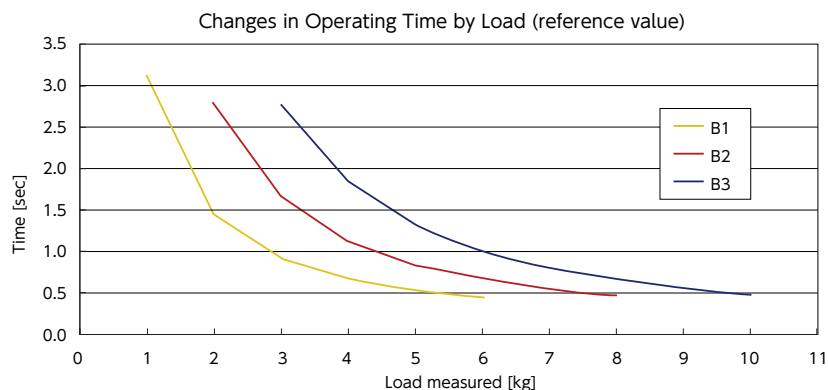

[Examples of Specifications Used]

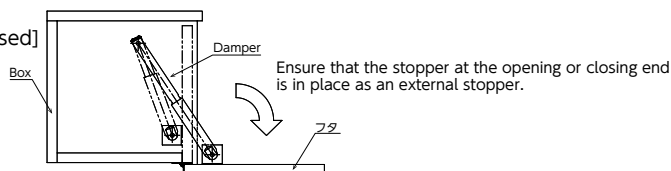

<Optional Parts

Model
OP-230-01
Model
OP-230-02

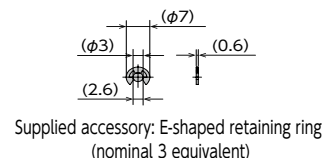
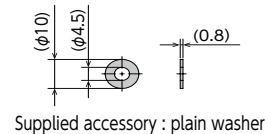
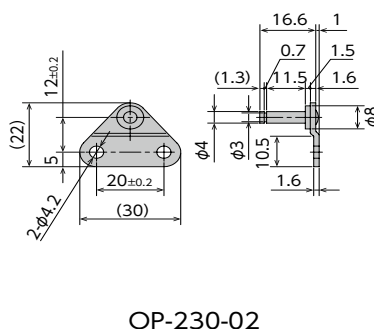
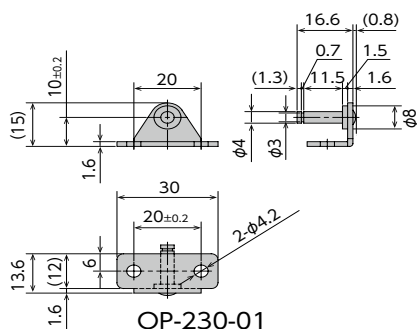

- Exclusive mounting fixture for FPR
- Facilitates the absorber mounting.
- A plain washer and E-shaped retaining ring are supplied to OP-230-01 and OP-230-02 each.
- Material: Metal

Precautions for Use

- * The soft absorber generates the drag in the drawing direction.
- * Unusable to generate the resistance in the pushing direction.
- * Use with an external stopper.
- * Ensure that sufficient mounting strength is secured for this product.
- * 2 or more of this product can be used in parallel.
- * Do not use this product in a vacuum or a location where it may come in contact with oil.
- * Ensure that an eccentric load is not applied to the soft absorber.
- * Do not pull the soft absorber beyond the stroke used. (This will cause the damage or failure of the soft absorber.)
- * Do not press the soft absorber in beyond the stroke used. (This will cause the damage or failure of the soft absorber.)
- * When the gap between the pressing time and the returning time of the piston rod is large, the durability may be affected. Confirm its performance in an actual machine before use.
- * For the products with cover, do not pull the cover part. When you need to pull the product, insert a rod into the $\phi 4$ through hole and pull the product by holding the rod.

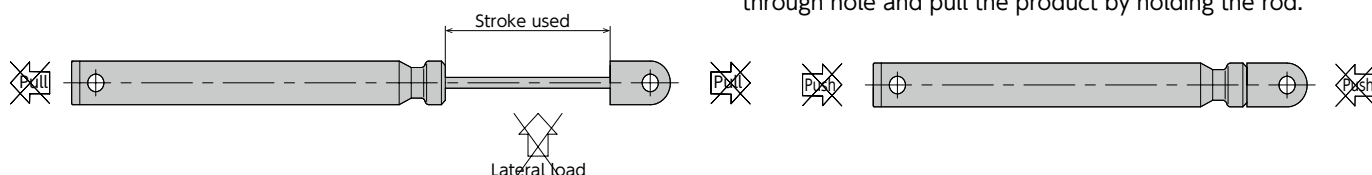

Soft Absorber

U Packing Seal

Fixed Type

Adjustable type

Self-adjusting

FPA-1475 Series

RoHS Compliant

●Products specification might be changed without notice.



Model Description

F P A — 1 4 7 5 B 1 — S W

① ② ③ ④ ⑤ ⑥

- ① Series name
- ② External diameter
- ③ Stroke
- ④ For self-returning B : Without self-returning
With/Without spring
- ⑤ Symbols indicating characteristics
- ⑥ Symbols indicating form SW : Without cap

External Dimensions

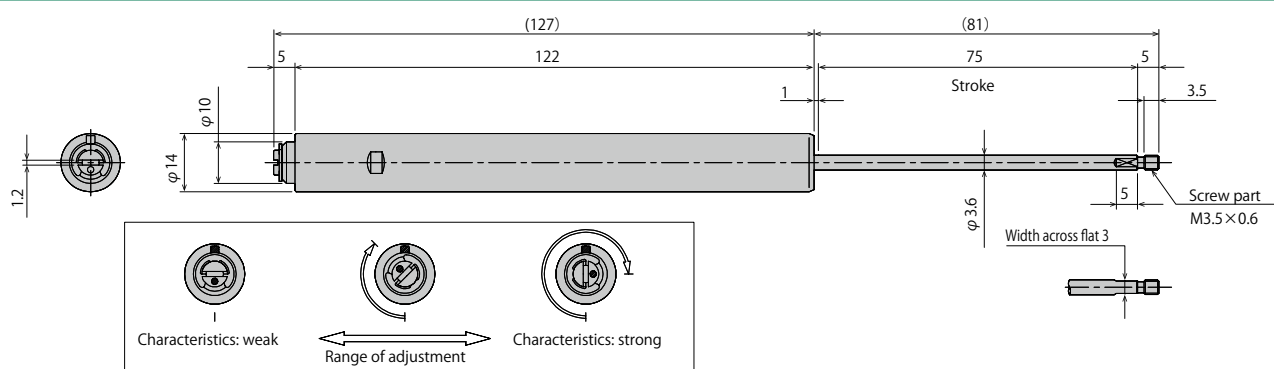

Specifications

Model	Stroke [mm]	Mass [g]	Main unit material	Range of impact rate [m/s]	range of operating temperature [°C]	Range of storage temperature [°C]
FPA-1475B1-SW	75	38	Resin	0.8 or lower	5~40	-10~50

Graph of Impact Rate/Mass of Colliding Object with the Condition of Horizontal Impact and No Thrust

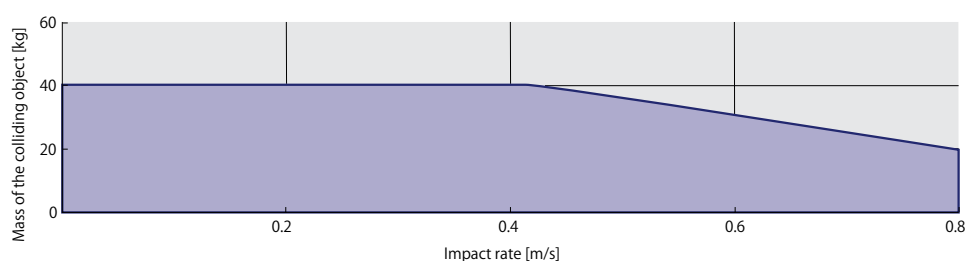

Precautions for Use

- * The series do not have the self-returning function. The piston rod needs to be pulled out by external forces.
- * Use the product with the external stopper within the stroke range.
- * Ensure that sufficient mounting strength is secured for this product.
- * Do not use this product in a vacuum or a location where it may come in contact with oil.
- * Ensure that an eccentric load (lateral load) is not applied to the soft absorber.
- * When the gap between the pressing time and the returning time of the piston rod is large, the durability may be affected. Confirm its performance in an actual machine before use.